



58 / **58** / 64 / 88
COUPE RPH

STANDARD SPECIFICATION

EUROPA VERSION

DIMENSIONS AND MAIN CHARACTERISTICS

Length Overall L_{OA} (Incl. swim platform excl. anchor roller)	18,58m
Hull Length L_H ISO 8666 (Net GRP - Swim platform excluded)	17,18m'
Waterline Length L_{WL} ISO 8666 (Full load conditions)	17,00m
Hull Beam B_{Hmax} ISO 8666 (@ Mid-ship section)	5,36m
Max Draft - T_{MAX} ISO 8666	1,24m
Loaded-Displacement Mass - mLDC ISO 8666	34,5 tonnes (with VOLVO D11) 36 tonnes (with VOLVO D13)
Light Craft Condition Mass - $m_{LCC ISO 8666}$ (= Dry displacement, no crew, no luggage)	28 tonnes (with 2 x VOLVO D11) 29,5 tonnes (with 2 x VOLVO D13)
Diesel Tank Capacity	3600lt
Fresh Water Tank	800lt
Black Water Tank Capacity	450lt
Gray Water Tank Capacity	225lt
Cabins	3 standard + 1 (optional crew cabin)
Beds	6 + (1 crew)
Heads	3 + 1 (crew head)
Building Material	GRP / Carbon hybrid fiber
Hull Type	Semi-displacement
Exterior Styling & Concept	Frers Naval Architecture & Engineering
Interior Decor	Design Studio Spadolini
Hull Design	Frers Naval Architecture & Engineering
Engines	VOLVO D11 670HP x 2 VOLVO D13 900HP x 2
Marine Gears	ZF 325 IV (VOLVO D11) ZF 335 IV (VOLVO D13)
Reduction Ratio	2.037: 1 (ZF 325 IV) 1.964: 1 (ZF 335 IV)
Transmission	V drive
Propeller Diameter (Max)	800mm
Max Speed	25 knots 28 knots
Cruising Speed	16 knots
Economy Cruising Speed	10 knots
Range 10 kn (Incl. 10% reservoir)	850NM
Certification	CE Category A

NOTE: All performance specified in the table above are design data and applies to a standard configuration boat (standard equipment installed as per this standard list) with clean keel, propellers, and rudders. Furthermore, the performance levels indicated above have been defined under good sea and wind conditions (Beaufort Scale level 1, Douglas Scale level 1, ambient $T < 25^\circ$, seawater $T = 15^\circ$, atmospheric $P = 103250$ Pa) with 2 people on board, 25% fuel, and fresh, grey and black water tanks empty. Different or harsher sea conditions and additional selected optional equipment may affect the performance.

STRUCTURE OF THE BOAT

The structural design is compliant to EN-ISO 12215. The hull, deck and superstructures are constructed in sandwich technology. Entire boat have been built using the vinylester resin infusion technique and assembled with structural adhesive engineered for marine application. Thanks to the vinylester resins maximum resistance to osmosis and better surface finishing Sirena Marine is therefore able to provide a **5-year warranty against osmosis**. This construction technology reduces weight and improves construction quality and consistency. Superstructure made from **carbon hybrid fabrics for improved lightness and strength**. Bulkheads are made in PVC sandwich and secondary bonded to the hull with lamination.

SEMI-DISPLACEMENT HULL

A semi-displacement vessel can take advantage of **increased power** and can achieve **greater speeds** when needed. Most of the time, semi-displacement vessel operates in displacement mode and is very **fuel-efficient**. Due to the lesser draft as compared to full displacement vessels, semi-displacement vessels have less “wetted surface area”, requiring less horsepower to propel the hull through the water. A semi-displacement hull can achieve about 35% more speed with the same engine load requirement as compared to a full displacement hull form, or conversely at the same speed use significantly less fuel and energy. The hard chine hull of a semi-displacement vessel is inherently more stable than a rounded bottom full displacement hull. Semi-displacements vessels are far more comfortable at anchor than any rounded bottom design.

EXTERIOR

HULL

External surface finished with high resistance white gelcoat
Moulded with tunnel for bow thruster and reinforcement for stern thruster
Waterline boot top in burgundy red
Antifouling painting

HARDTOP

Hybrid carbonfiber hardtop
Mast for 18" 4kW HD radar, VHF antenna, horn and optional navigation equipment
Fixed skylight windows
Navigation lights

SUPERSTRUCTURE

Hybrid carbonfiber superstructure
Deckhouse with front and side visors
Tempered laminated glass deckhouse windows
Europa grey side windows and neutral colour front windows
Manual sliding window in the helm station (port side)
2 windscreen wipers with washer
Navigation lights (red, green)
Sirena Yachts logo on deck house
Courtesy lights on steps

FOREDECK

Stainless steel pulpit
Anti-skid surface
2 stainless steel hawses
2 mushroom bollards
Fixed bow anchor roller
Stainless steel anchor shield on bow
1700W Lofrans anchor windlass with mooring support
Ultra 45kg stainless steel anchor
75m high resistance chain with 10mm diameter
Chain wash down system
Self draining chain locker and housing for 8 fenders
Sofa with removable cushions and storage underneath
Sunbathing area with removable cushions and storage underneath.
Stainless steel handrails and Plexiglas® cup holders
2 lockers around the sofa

SIDE WALKWAYS

Side walking areas and first steps of bow area entrance in teak
2 fuel fillers covered by GRP
2 stainless steel fairlead with cleats inside at mid-ship
Fresh water filling inlet
Black water deck suction discharge outlet
Grey water deck suction discharge outlet
Courtesy lights on steps
Teak gunwale

AFT COCKPIT

Teak covered steps from platform to cockpit

Teak covered floor

Side boarding gate on each sides

Saloon door with 4 stainless steel and tempered glass panels. 2 panels fixed. 2 panels sliding from center to sides

Courtesy lights on steps from platform to cockpit

4 stainless steel fairlead

2 stainless steel mushroom bollard

LED Spotlights under the flybridge with dimmer

2 Stainless steel and Plexiglas® gates with Sirena Yachts logo

Cockpit sofa with cushions

LED Spotlights

2 watertight loudspeakers

Manual activation of the fire extinguisher system

Stainless steel handrails next to stairs

Engine room access via GRP hatch

Soft patch for engine and generator removal

Access to aft storage area via GRP hatch on aft seat

AFT PLATFORM / TRANSOM

Manual sliding swim ladder integrated in the platform

Hydraulic tenderlift with 400kg net working load capacity

Spray Anti-skid surface

Glass on transom with integrated openable porthole

Shower with hot and cold water mixer

Fresh water shore connection

Shore power socket 63A

Maximum tender dimensions on the platform 2,80 x 1,40m

2 stainless steel mushroom bollards

INTERIOR

GALLEY

Galley at the entrance of saloon on starboard side

Wooden flooring

Low and high cupboards and bottle drawer starboard side

No.2 Drawer type fridge/freezer

Storage area with shelves at portside

Worktop in Corian

Stainless steel sink

Water mixer

Four-hob glass ceramic cooktop

Stainless steel pan holder

Combi Oven

Extraction hood

LED spotlights

Rubbish bin

Curtain on the entrance door

1 AC socket

SALOON / DINETTE

Carpet flooring

U shape sofa and fixed table on portside

L shaped sofa on starboard side

Space to house TV lifting system at starboard side

LED spotlights with dimmer

Fixed glass sunroof

Manuel operated glass sunroof blinds

Roman curtains on side windows

Fusion Marine entertainment system

TV antenna predisposition

2 AC socket

2 loudspeakers

Drawers under all sofas

Footrest (under steering wheel)

Service and engine batteries switches and engine room lighting switch at the entrance portside

Helm station equipped with:

Helm seat on port side

Storage area next to helm station

1 AC socket

2 Panel cabinet for storage next to the helm station

Steering wheel

Garmin 10" MFD GPSMAP 8610

Garmin GHS 11 VHF Radio

Depth/Speed transducer

Spotlights switch

Wheelhouse electrical panel next to helm seat

Windscreen washing switch

Anchor windlass control

Navigation/anchor lights switch

12V socket

USB socket

Interceptor control

Bow-thruster joystick

Chain counter

Horn switch

Fire extinguisher alarm panel

Compass

Monitoring system functions integrated in to chartplotter displays:

Grey water level gauge

Black water level gauge

Fresh water level gauge

Shore power connection status-alarm

Tenderlift platform position status

Bilge high level alarm

STAIR TO LOWER DECK

Carpet on steps
Courtesy lights
Handrail

OWNER'S CABIN

Located at amid-ship
Carpet flooring
En-suite head
2 AC sockets
Double bed
Mattress
2 nightstands
2 full size wardrobes with hangers and shelves
Full size mirror
TV Antenna predisposition
Vanity on port side
Sofa on starboard side
Storage on port side and starboard side
LED spotlights
2 wall lights
Roman curtains
2 scenic windows

OWNER'S HEAD

Located on the forward starboard of the owner's cabin
Private access from the owner's cabin
Corian flooring in head
Corian flooring in shower area
Toilet
Shower area with Plexiglas® door
Showerhead
Shower mixer
Washbasin
Water mixer
Bathroom counter top in Corian
Mirror
Cabinet underneath the sink
Air extractor in shower
LED spotlights
1 portlight
AC socket with protection
Toilet accessories
Venetian blind

VIP CABIN

Located on lower deck fore side

Carpet flooring

En-suite head

Double bed with underneath storage

Mattress

2 wardrobe with shelves on both sides

TV Antenna predisposition

LED spotlights

2 wall lights

Roman curtains

2 scenic windows with one porthole each

VIP CABIN HEAD

Located on starboard side with private access from VIP cabin

Corian flooring in head

Toilet

Shower area with Plexiglas® door

Showerhead

Shower support with adjustable height

Shower mixer

Corian flooring in shower area

Washbasin

Water mixer

Bathroom counter top in Corian

Mirror

Cabinet underneath the sink

Air extractor in shower

LED spotlights

1 window with porthole

Venetian blind

AC socket with protection

Toilet accessories

GUEST CABIN

Located on port side

Carpet flooring

Direct access to day head

Twin beds with underneath storages

Mattress

1 nightstand between two beds

Full size wardrobe with hanging space mirror and shelves

One portlight and scenic window

Roman curtain

LED lights

1 wall lights

AC socket

GUEST'S / DAY HEAD

Located on port side
Entrance from guest cabin and corridor
Corian flooring in head
Washbasin
Water mixer
Bathroom counter top in Corian
Mirror
Cabinet underneath the sink
Air extractor fan
Toilet
Toilet accessories
Shower solution
LED lights
AC socket with protection
Window with porthole

AFT STORAGE AREA (OPT. CREW CABIN)

Access from aft cockpit via GRP hatch
Free space for storage
LED spotlight

ELECTRIC SYSTEM

Halogen free and self extinguishing cables
Bounding system with 2 sacrificial anodes
Grounding system
Galvanic isolator and to prevent galvanic corrosion
230V AC - 60Hz with 63A shore connection
24V DC - 12V DC with negative grounded
Inverter 1000W - 24 / 230V - 50Hz

GENERATOR

1 Cummins Onan generator 4kW - 50Hz (in the engine room)

PROPULSION SYSTEM

VOLVO D11 670HP x 2
ZF 325 IV Gearbox (Ratio 2.037 :1)
63,5 diameter duplex F51 Shaft (Shaft angle 8 degree)
Aluminium bronze P bracket
800 x 830 mm 5 blades Teignbridge proppellers
PSS Shaft seal

STEERING & MANOEUVERING SYSTEMS

Servo electric power assisted steering system and autopilot system
Electro hydraulic autopilot system
Rudder blade in aluminium bronze
Dynamic automatic trim control via interceptors
8 kW variable bow thruster- 24VDC, D. 250 mm

SHORE POWER CONNECTION

Shore power socket 230V – 50 Hz with 63A shore connection

Power lines protected by dedicated GFCI circuit breakers

15 meter shore connection cable

BATTERIES

8 x 95Ah batteries for service

4 x 180Ah batteries for engine start

1 x 95Ah battery for generator start

1 battery charger - 24V/80A for service

1 battery charger - 24V/30A for starting batteries

1 battery charger - 12V/15A for generator battery

BILGE SYSTEM

Nr. 1 x 24 V electrical bilge pump in engine room

Nr. 1 x 24V automatic electrical bilge pump 24V in the accommodation area

Nr. 1 manual bilge pump located at aft deck under mooring area. Two suction areas through a valve, one suction at accommodation area, one suction at engine room

4 Bilge level alarms

2 Bilge high level alarms

Engine room emergency pump through a diverting valve fitted on engine seawater cooling line

Each electric pump can be manually activated by switches placed in the helm station

FIRE EXTINGUISHING SYSTEM

Seafire Novec manual and automatic extinguishing agent in the engine room

Automatic shut down system

Alarm on helm station

FUEL SYSTEM

2 x stainless steel tanks (total 3.600 liters) located in the engine room

Fuel level indicator for each tank on monitoring system

Visual level gauge on port and starboard tanks

1 single separation filter for generator

2 single VOLVO separation filters for engines

FRESH WATER SYSTEM

Nr. 1 HDPE tank (800L)

Self priming fresh water pump

Tank level indicator and empty status integrated in the monitoring system

60 liters water heater 220V - 1200W

Hot and cold water in all head rooms, galley, cockpit

Cold water outlet in engine room

Filling cap on the side-walking

Shore fresh water connection

BLACK WATER SYSTEM

Nr. 1 HDPE tank 450 liters capacity

Tank level indicator integrated in the monitoring system

3/4 and full tank indication in the heads

Fresh water toilet flushing

Holding tank discharge via suction on deck

Overboard discharge of waste water via a dedicated line at the exit of the holding tank

GRAY WATER SYSTEM

Nr. 1 HDPE tank 225 liters capacity

3 sump tanks under masterhead

3/4 and full tank indication in the heads and galley

Water drainage from showers and sink into tank

Level sensor integrated into the monitoring system

Water drainage via manifold (24V membrane pump)

Manual/Automatic overboard discharge

SEA WATER SYSTEM

2 sea water intakes with filters and valves for engine cooling system

1 sea water intake with filter and valve for generator cooling system

1 sea water intake with filter and valve for chain wash and deck wash system

ENGINE GAS EXHAUST SYSTEM

Water-cooled engine exhaust, thermal-insulated stainless steel manifolds

Fiberglass muffler integrated into the hull structure, submerged outlets, and bypass line on hull sides

VENTILATION / EXTRACTION

Air inlet and outlet openings with a GRP cover on hull sides

Nr. 2 24V air inlet fans at ventilation channel

Nr. 4 24V air extraction fans at ventilation channel

Mist eliminator at each channel

OTHER EQUIPMENTS

Four 12 meters mooring lines in 18mm diameter

8 fenders with 8mm diameter lines

Fender covers with Sirena Yachts logo

Owner's manual

CE certificate

Nr. 2 leather fender hook

Sirena Yachts reserve the right to change specification without any prior notice.
Effective from 15th of March **2020. REV. 01** This replaces all previous lists."

Sirena 58 Coupe Layout

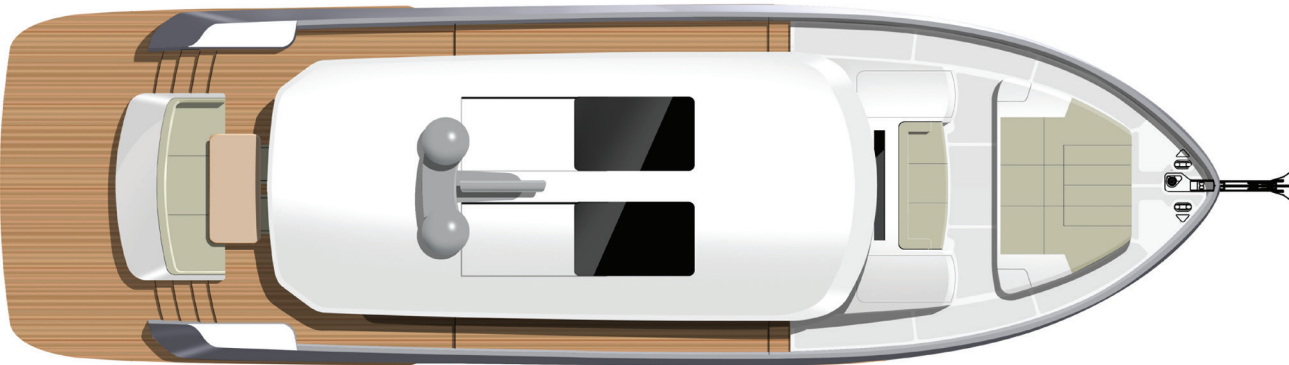

Main Deck Standart Layout

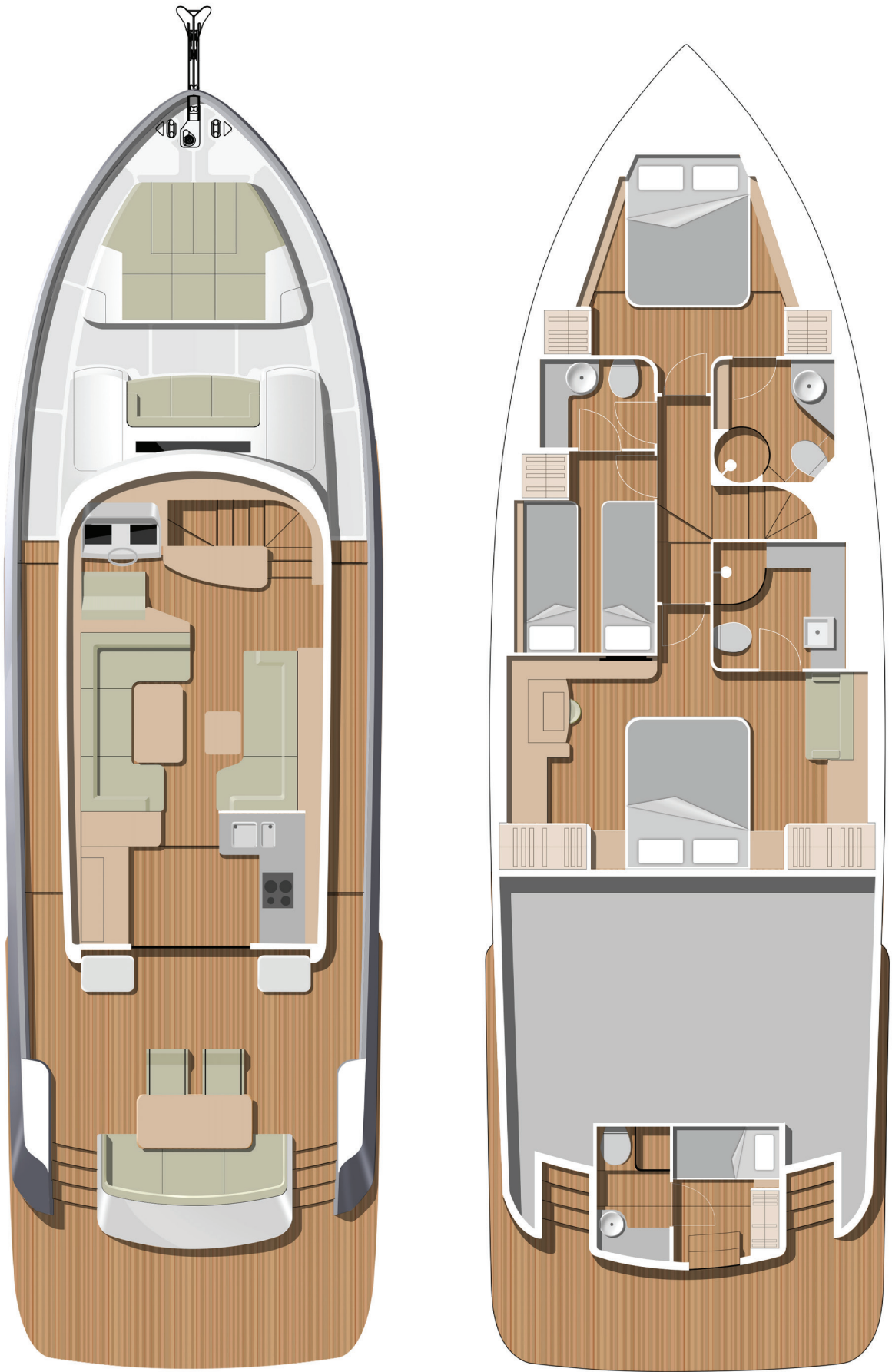

Optional 2 Cabin Layout

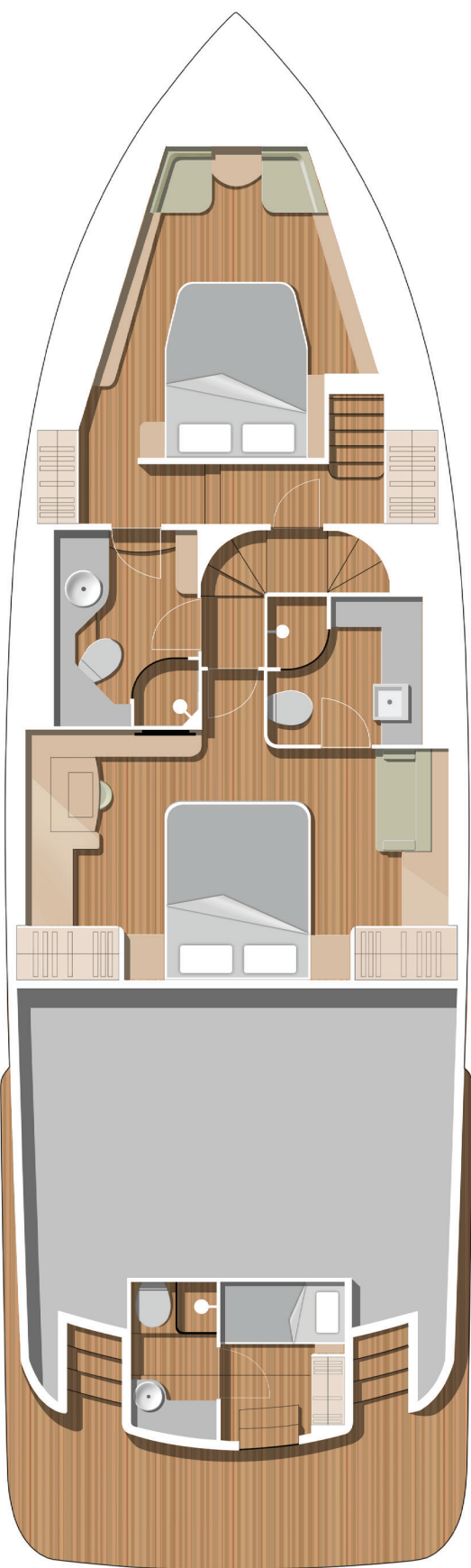

Optional 3 Cabin Layout

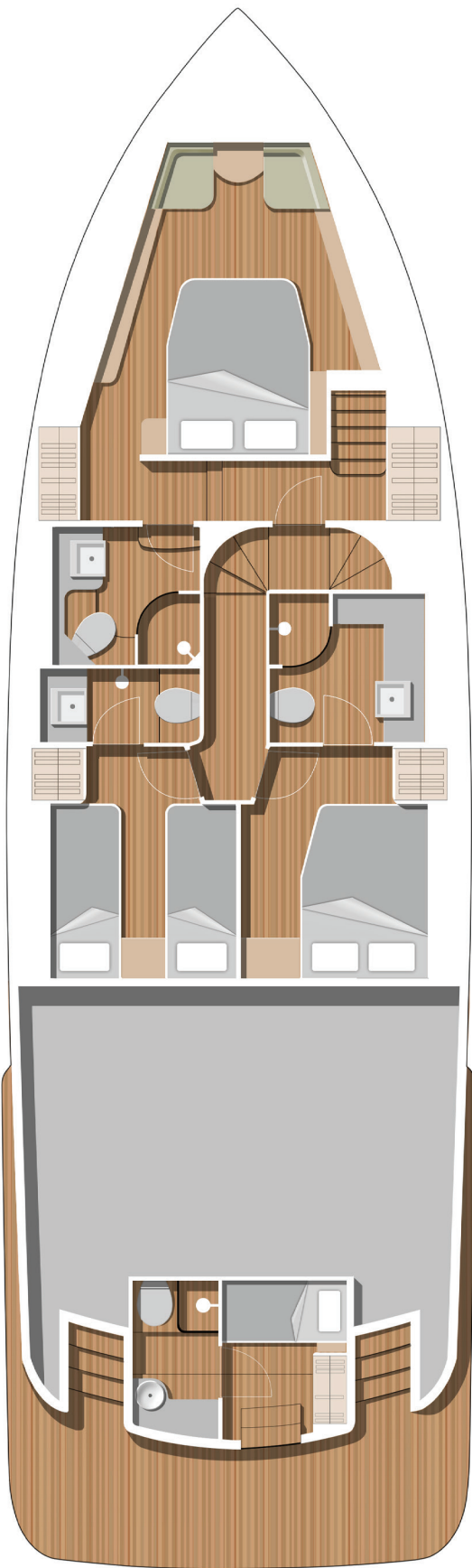

SIRENA  YACHTS

A brand of  SIRENA MARINE